

**PLAY TIME SERIES
MODEL - MAVERICK**

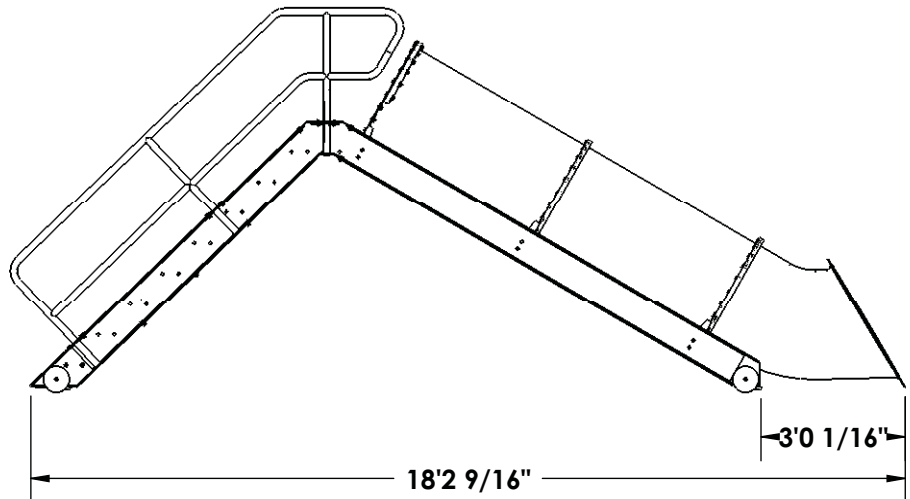
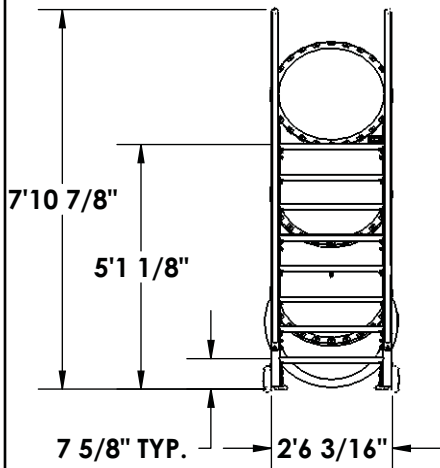
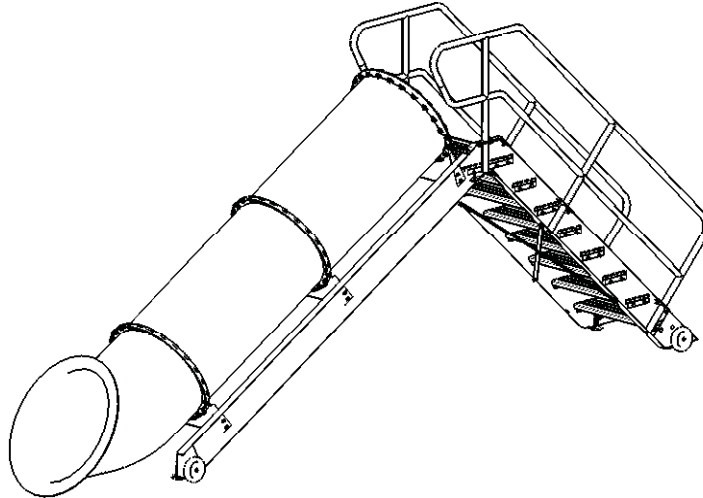

NOTE:

1 DIMENSIONS VARY WITH SPECIFIC APPLICATIONS.
SPECIFICATIONS ARE NOMINAL AND ARE SUBJECT TO CHANGE.
PLEASE CONTACT SPECTUM PRODUCTS FOR CUSTOM APPLICATIONS.

SPECTRUM
Products

7100 Spectrum Lane
Missoula, Montana 59808
406.542.9781 * 800.791.8056
Fax: 406.542.1158
www.spectrumproducts.com

ENGINEERING DATA

PRODUCT:	MAVERICK
PRODUCT #:	86520-00
REVISION:	A
MATERIAL:	300 SERIES STAINLESS STEEL

Water Slide, Maverick, part number 86520-00

The slide shall be designed in accordance with ASTM F 1487-01, and CPSC Part 1207, and for use on in-ground commercial swimming pools that have a minimum water depth of 4'. All metallic components of the slide, its frame and stair rails, shall be fabricated of stainless steel. Flume shall be fabricated of color-impregnated, ultraviolet stabilized polyethylene. The slide shall be portable and equipped with transport wheels. The slide shall consist of the following components:

Frame

The slide frame shall be fabricated from 12-gauge, 300 series stainless steel.

Frame Platform Deck and Step Treads

The top platform and step treads shall be fabricated from 1", ultra-violet ray stabilized, non-slip, structural fiberglass T-bar.

Rails

Stair rails shall be fabricated from 1.25" O.D. x 0.065" wall thickness, 300 series stainless steel, tubing and shall be of the dual horizontal (²H) design.

Wheels

Four, 6" diameter removable polyethylene wheels shall be provided with the slide to facilitate ease of transport.

Flume

The slide flume sections shall be 27" in diameter and shall be rotationally molded of ultraviolet stabilized polyethylene.

Water Supply

The entrance flume will be equipped with two-spray nozzles that will direct a fine spray of water into the flume. Water supply tubing will be installed so as not to allow patron access. A ³/₄" female threaded water connection shall be supplied and shall be located at the base of the frame assembly.

Warranty

Two year limited warranty.



7100 Spectrum Lane ~ Missoula, Montana 59808
800.791.8056 ~ 406.542.9781
Fax: 406-542-1158
www.spectrumproducts.com